



FENCE | RAIL | DECK

**CANADIAN ENGINEERED.
SERVING CANADIANS.**



Luxeline Fence Installation Guide

Section 1 Safety Precautions









Before starting installation, make safety your first priority. Always wear safety gloves, steel-toe boots, and protective eyewear. When using power tools, wear long sleeves and hearing protection.

Inspect the worksite for potential hazards before beginning. Whenever possible, have a second person assist with lifting, leveling, or alignment tasks.



Section 2 Tools & Materials

> Required Tools

- | | | | |
|--|---|---|--|
|  Tape Measure |  Level & String Level |  String Line |  Post Hole Digger |
|  Shovel |  Table or Circular Saw |  Drill |  Hammer |

> Additional Materials

- Gravel for Drainage
- Fast-Setting Post Cement
- Bucket or Container for Mixing Cement



Section 3

Fence System Components

Each component is precisely engineered for modular assembly, allowing quick and consistent installation.

Section 4 Measure and Post Layout

Begin by determining where each fence run will start and end. Drive stakes slightly beyond the first and last post positions.

Stretch a guide string tightly between the stakes, keeping it straight and level. Ensure the string is positioned at the correct height.

To mark the remaining post centers, measure from the center of one post to the next. This marks the location of each hole along the fence line. (You can always trim the panels later for a perfect fit.)

Shape the exposed surface of each concrete footing so it slopes gently away from the post to promote drainage.

Allow the concrete to fully cure before installing the fence panels — typically 24 to 48 hours, depending on weather conditions.

LUXELINE

Aluminum Posts

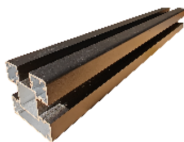

composite board



top rail (reinforcement rail)



Bottom rail



Post base



Rail insertion plate



Accessories



Section 5

Dig Holes for End and Corner Posts



Before digging, check local building codes and zoning rules, as requirements may vary by municipality.
If unsure, consult a qualified contractor or inspector.

> Post Spacing

Measure from the center of one post to the center of the next to ensure proper panel alignment.

The center-to-center distance between post holes should equal the panel length + 6.5 cm (2½ in.).

This extra space accounts for post thickness and installation clearance.

Example:

If your panel length is 176 cm (69¼ in.), the distance between post centers should be about 182.5 cm (71⅞ in.).

> Hole Depth

In British Columbia, aluminum fence posts should be set at least one-third of the total post length, with a minimum embedment of 61 cm (24 in.).

In colder regions, dig below the frost line to prevent movement caused by frost heave.

> Hole Diameter

A hole diameter of roughly 23 cm (9 in.) is recommended.

This provides adequate space for drainage gravel, post alignment, and sufficient concrete backfill.

> Backfill Process

Place 10 to 15 cm (4 to 6 in.) of drainage gravel at the bottom of each hole to improve runoff and reduce frost pressure.

Note: The gravel is part of the total hole depth.

Posts must still extend 30 inches (76 cm) below grade, not 30 inches plus gravel.

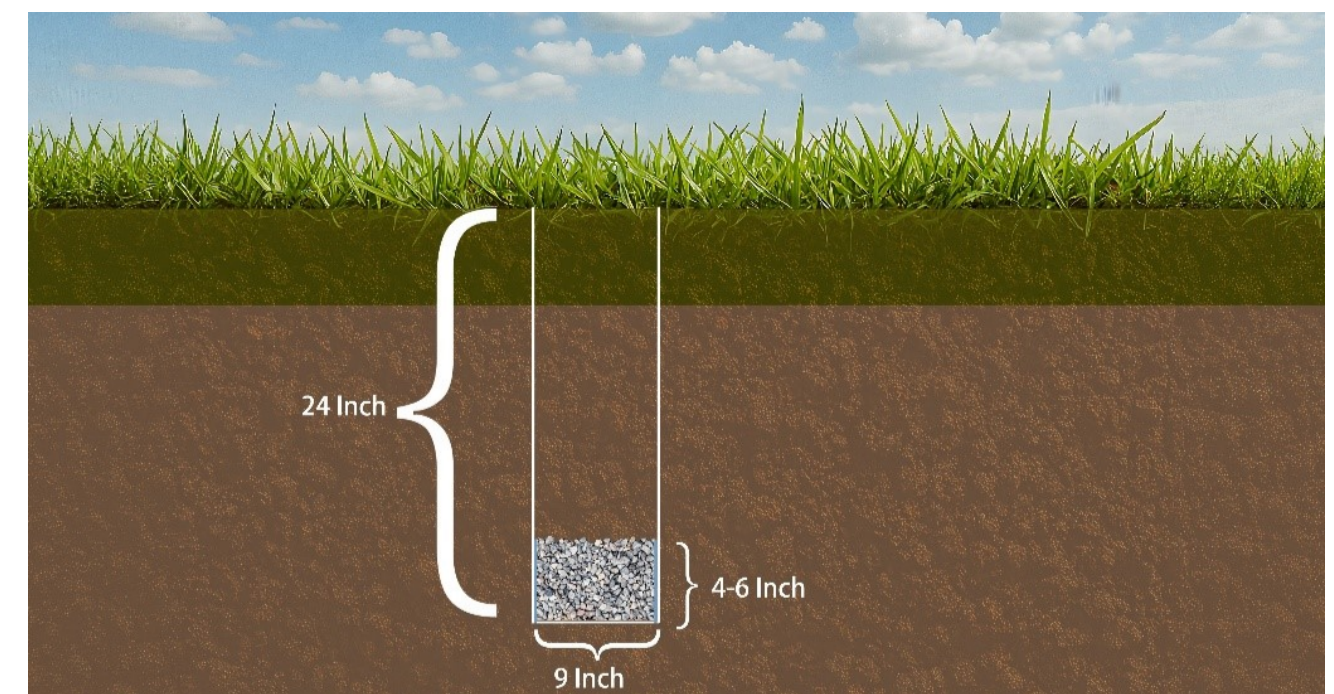

Section 6

Concrete Curing & Post Installation

Once the holes are prepared, pour concrete into each one. Insert the main fence posts while the concrete remains workable — do not wait for it to harden.

Ensure each post is perfectly plumb using a level, and adjust as needed before the concrete begins to stiffen.

LUXELINE



> Post Spacing

Maintain consistent spacing: panel length + 6.5 cm (2½ in.).

For example, if your panel is 176 cm (69¼ in.), post centers should be 182.5 cm (71⅞ in.).

> Curing Time

Allow the concrete to partially cure for 24 to 48 hours, depending on temperature and humidity, before proceeding with panel installation.

> Leveling the Inner Post

Ensure the inner post is level and centered before the concrete sets.

This provides proper panel support and allows for thermal expansion.

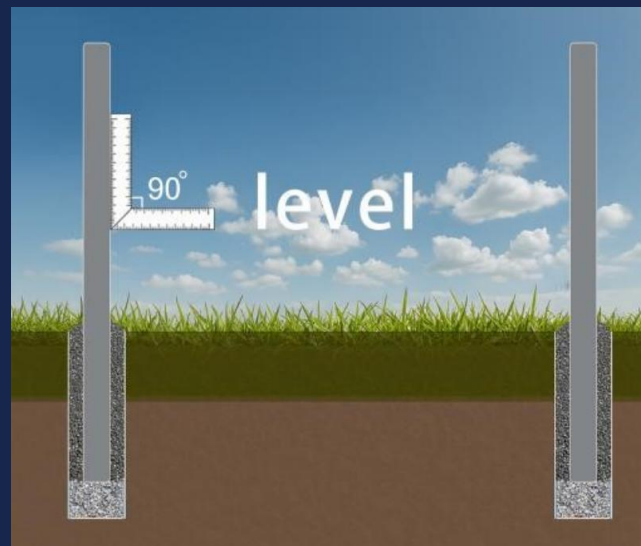

Section 7

Adjust and Install Aluminum Fence Posts

If necessary, cut the posts to match your layout or uneven ground before setting them. Always verify local building requirements and, when in doubt, consult a professional to ensure compliance.

After trimming, place each aluminum post into the prepared hole. Use a level to make sure the post is straight and aligned with the fence line before securing it.

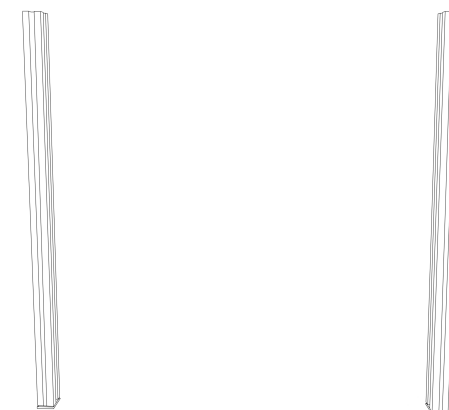

Section 8 Fit the Bottom Rail

Step 1 – Insert the Spacer

Slide the spacer into the aluminum post channel.
Cut the spacer to fit your project requirements.

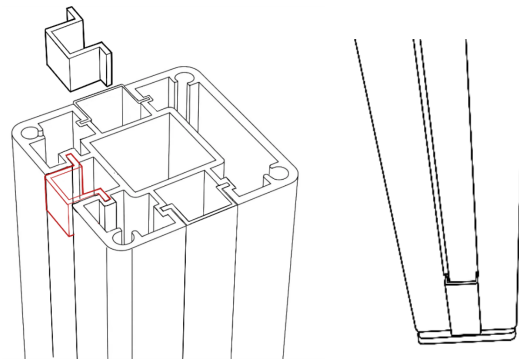

Step 2 – Attach the Insertion Plates

Fasten an insertion plate to both ends of the bottom rail.
Ensure the narrow tab with the single screw hole faces upward.
Secure the plates with screws, leaving a small gap at each end for thermal expansion and contraction.

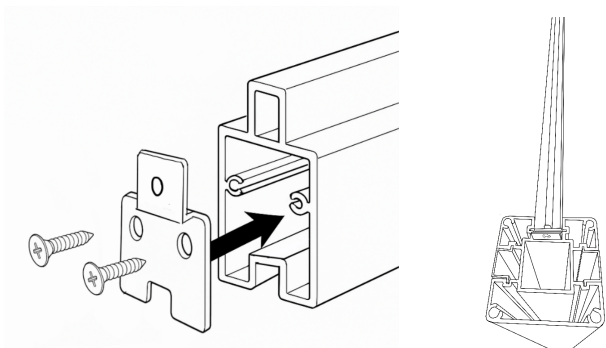

Step 3 – Install the Bottom Rail

Insert the bottom rail into the post channels.
Drive a screw through the top hole of each insertion plate to lock it in place.
Verify that the post and rail are level before tightening completely.

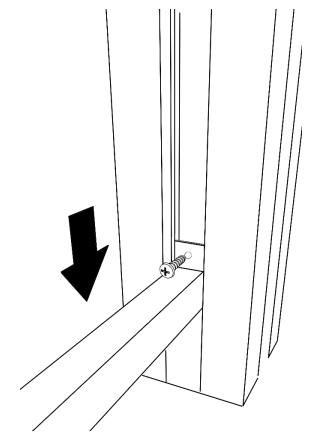

Section 9 Insert the Panels

Slide all composite panels into the post channels.
If post spacing is accurate, this step should go smoothly and the panels will fit snugly.
Optional: Add one or more reinforcement rails to increase rigidity and overall stability.

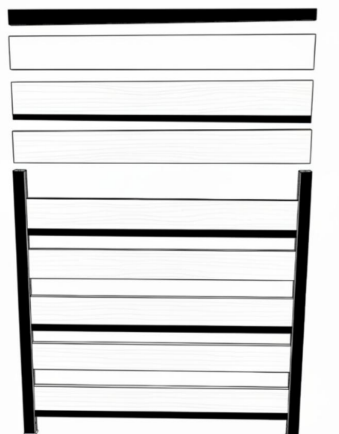

Section 10 Install the Top Rail

Install the top rail using the same method as the bottom rail.

Fasten insertion plates to both ends, with the narrow tab and single screw hole oriented upward. Secure the plates with screws, leaving a small expansion gap at each end.

Slide the top rail into the post channels and confirm it is level and fully seated.

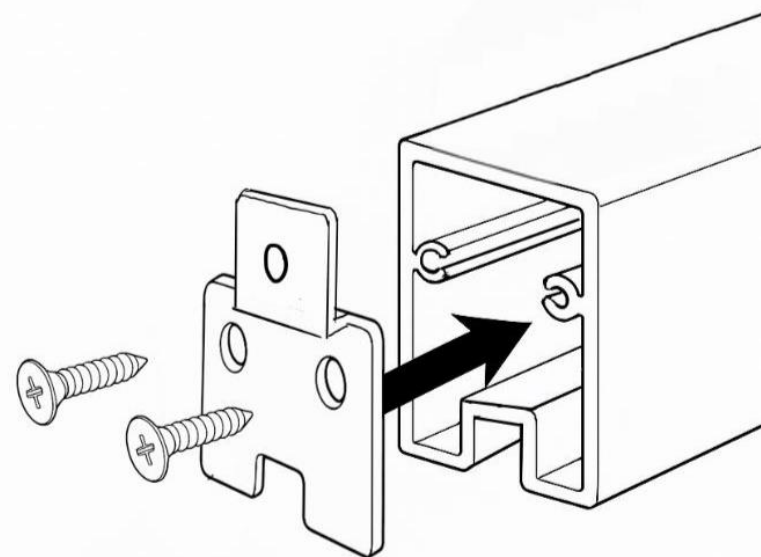

Section 11 Install the Spacer and Post Cap

Insert the top spacer and cut it flush with the top of the aluminum post. If needed, trim posts to their final height so the fence line appears even and consistent.

Apply a small bead of exterior-grade silicone sealant inside the post cap or around the top edge of the post.

Press the cap firmly into place to ensure a watertight seal.

Wipe away any excess sealant and allow it to cure per the manufacturer's directions for a clean, professional finish.

